

1 May 23, 1990
2 3001H:hdm

Introduced by: PULLEN

Proposed No. 90 - 483 4

3
4 **9594**

ORDINANCE NO. 9594

5 AN ORDINANCE relating to the annexation of an
6 area known as 318-W to Soos Creek Water and
Sewer District for water service.

7 STATEMENT OF FACT:

8 1. A notice of intention proposing the annexation of an area
9 known as 318-W to Soos Creek Water and Sewer District for water
10 service, was filed with the county council effective May 23, 1990.

11 2. Soos Creek Water and Sewer District for water service, has
12 found the petition for annexation to be sufficient and has, by
13 Resolution No. 1491-W concurred with the proposed annexation.

14 3. Soos Creek Water and Sewer District for water service,
15 filed a Declaration of Non-significant Impact dated March 15,
16 1990, on the proposed annexation.

17 4. The county council held a public hearing on the 26th day
18 of August, 19 90 and has considered the criteria
19 set forth in R.C.W. 57.02.040.

20 BE IT ORDAINED BY THE COUNCIL OF KING COUNTY:

21 SECTION 1. The annexation by Soos Creek Water and Sewer
22 District for water service, of the area known as 318-W and
23 described in Section 4 herein is approved. This proposed
24 annexation is consistent with R.C.W. 57.02.040 as described in the
25 attached King County Council Annexation Report on 318-W.

26 SECTION 2. Soos Creek Water and Sewer District for water
27 service, is the appropriate entity to serve the area proposed to
28 be annexed.

29 SECTION 3. Completion of this annexation does not constitute
30 county approval or disapproval of any other permits, certifica-
31 tions, or actions necessary to provide water service to this
32 annexation area.
33

1
2 SECTION 4. The area known as 318-W to be annexed for water
3 service is described as follows:

4 Beginning at the Northwest corner of the South one-half of the
5 South one-half of the Northeast one-quarter of Section 10,
6 Township 22 North, Range 5 East, W.M., in King County,
7 Washington said point lies on the existing boundary of the
8 water service area of Soos Creek Water and Sewer District;

9 Thence Easterly, along the North line of said South one-half,
10 to the East line of the West one-half of the East one-half of
11 said South one-half;

12 Thence Southerly, along said East line, to the South line of
13 the Northeast one-quarter of said Section 10;

14 Thence Westerly, along said South line, to the Southwest
15 corner of said Northeast one-quarter;

16 Thence Northerly, along the West line of said Northeast
17 one-quarter, to the Point of Beginning.

18 INTRODUCED AND READ for the first time this 29th day
19 of May, 1990.

20 PASSED this 30th day of August, 1990.

21 KING COUNTY COUNCIL
22 KING COUNTY, WASHINGTON

23 Lois North
24 Chair

25 ATTEST:

26 Gerald A. Peterson
27 Clerk of the Council

28 APPROVED this 30th day of August, 1990.

29 J. Hill
30 King County Executive

SOOS CREEK WATER AND SEWER DISTRICT PROPOSED ANNEXATION 318W (WATER SERVICE AREA)

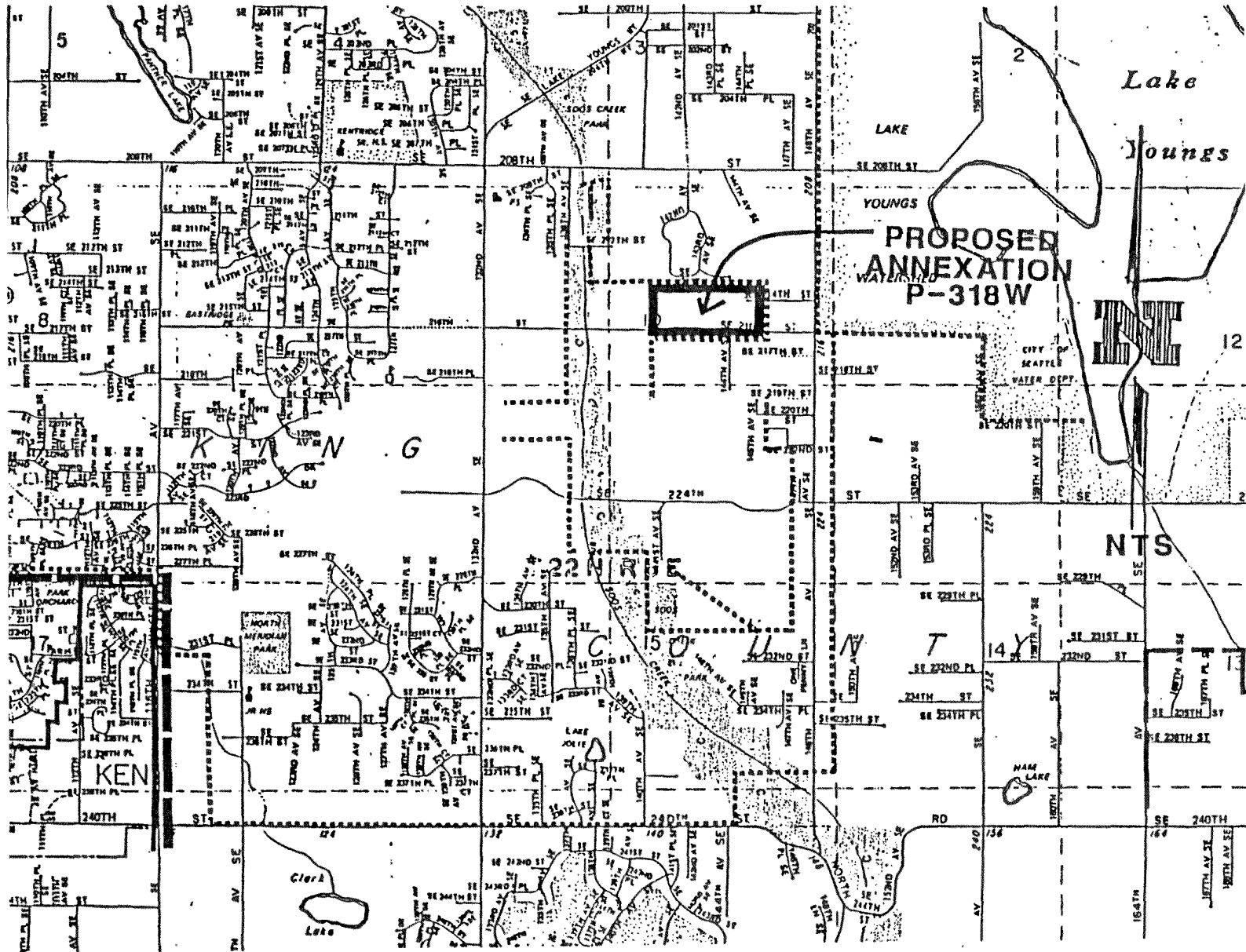

**PROPOSED ANNEXATION 318W
(WATER SERVICE AREA)**

**SOOS CREEK WATER AND SEWER DISTRICT
(WATER SERVICE AREA)**

CITY OF KENT

KENT MUNICIPAL WATER DISTRICT

COVINGTON WATER DISTRICT

ALL MAP WITHIN FIRE DISTRICT NO.37

**ALL MAP WITHIN KING COUNTY
SCHOOL DISTRICT NO.415**